

Pre-Assembly

PLANNING ASSEMBLY

Check the vanity for damage before installation. If any part of the vanity is missing or damaged, contact the Customer Service Team at 1-855-HD-GLACIER. Ensure that the vanity location is accessible to water supply and drain lines. It is suggested that you rough-in the water lines and drain before installing the vanity.

VANITY AND COUNTERTOP DIMENSIONS

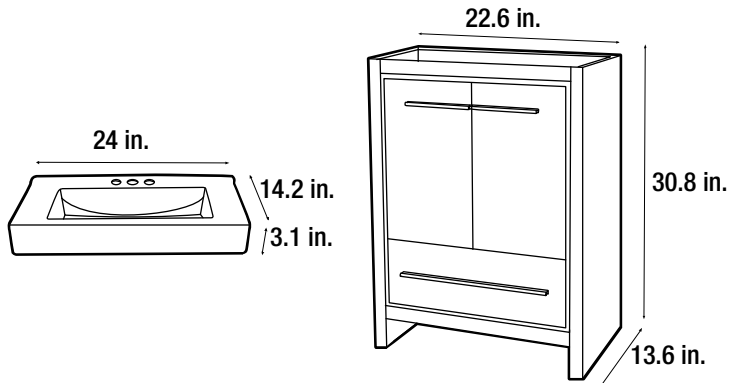

TOOLS REQUIRED

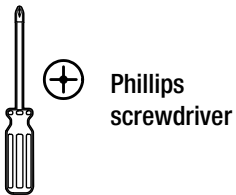

HARDWARE INCLUDED



NOTE: Hardware not shown to actual size.

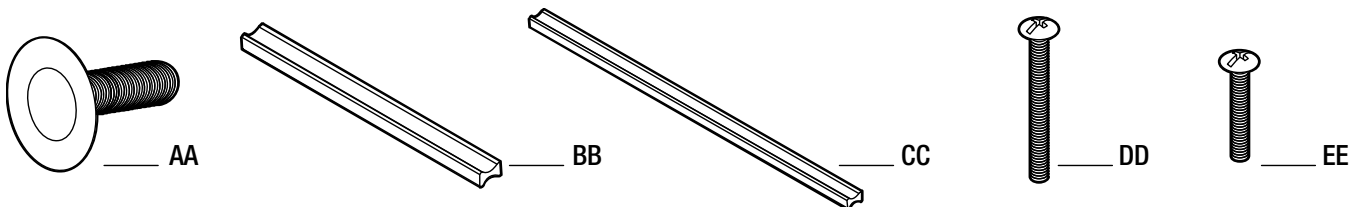

Part	Description	Quantity
AA	Level screw	4
BB	Door handle	2
CC	Drawer handle	1
DD	Drawer handle screw	2
EE	Door handle screw	4

Pre-Assembly (continued)

PACKAGE CONTENTS

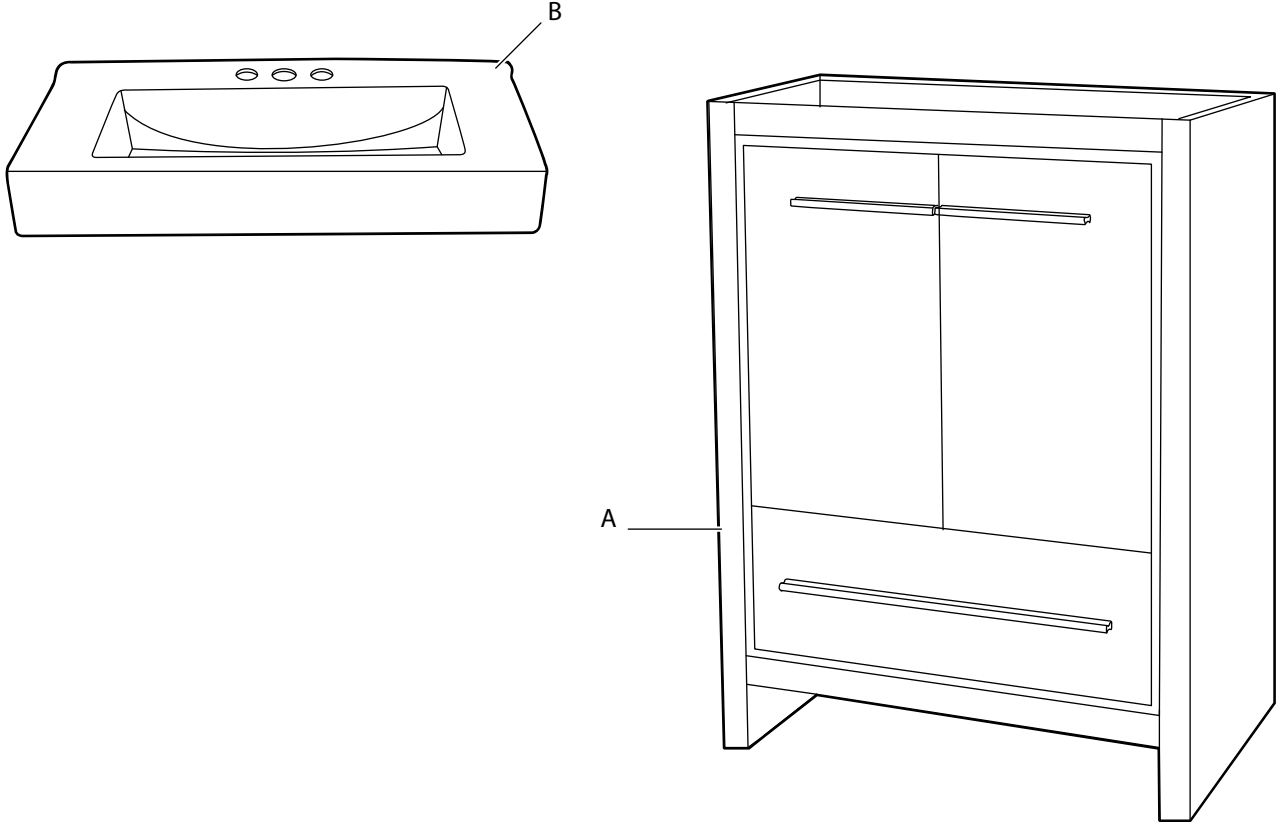

Part	Description	Quantity
A	Vanity body	1
B	Sink top	1

Assembly

1! Preparing the vanity

- ❑ From the back of the vanity body (A), push out the drawer and remove the cardboard under the drawer.

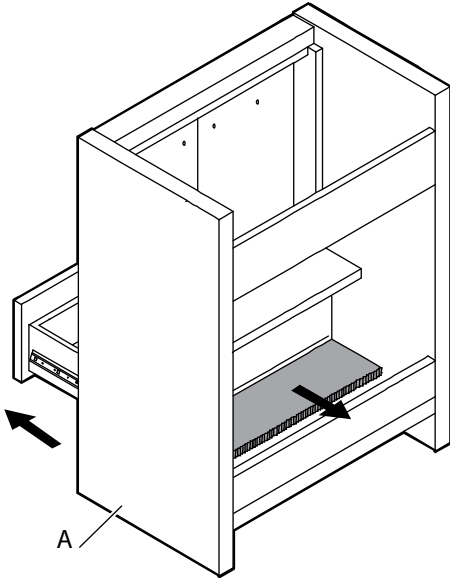

2 Installing the level screws

- ❑ Carefully lay the vanity body (A) down on a soft surface to avoid scratching the surface.
- ❑ Screw the level screws (AA) into the bottom of the vanity body (A).



NOTE: The level screws are used to ensure the vanity is level once placed in its final location. When assembly is complete and the vanity is in its final location, turn the screws clockwise or counterclockwise until you are certain the vanity is level on the ground.

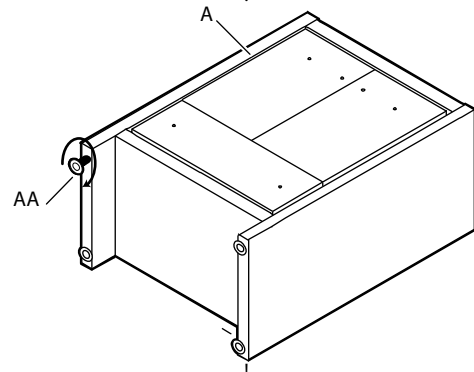

3! Preparing the vanity

- ❑ Attach a door handle (BB) to each door on the vanity body using the door handle screws (EE).
- ❑ Attach the drawer handle (CC) to the drawer on the vanity body (A) using the drawer handle screws (DD).

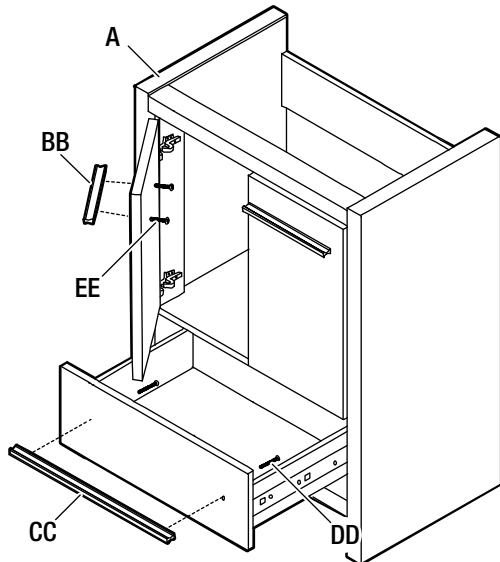

4 Installing the level screws

- ❑ Apply a small bead of silicone around the top perimeter of the vanity body.
- ❑ Carefully place the sink top (B) on the top of the vanity body (A). Wipe away any excess silicone.

